

Initial Harvest Calibrations Header Height

1. Press the **Wrench** button to access the setup page. Press on the **Grain Harvest** button.
2. Press on the **Header Tab**. Touch the head that is currently on the machine to highlight it. With the **head highlighted**, press the **Calibrate Header Height** button.
3. Read the message on the screen and then press the **Next** button. Raise the header all the way up, press **Set Max**. Next, lower the header all the way down, press **Set Min**. This only needs to be completed once per combine. **Press Next** to continue.
4. Select Crop. Raise or lower header to desired harvest height and press **Set Height**. Repeat for all crops.

Stop Height Values:

Corn: _____%

Soybeans: _____%

Other: _____%

5. Press the **Green Checkmark** to complete the calibration.

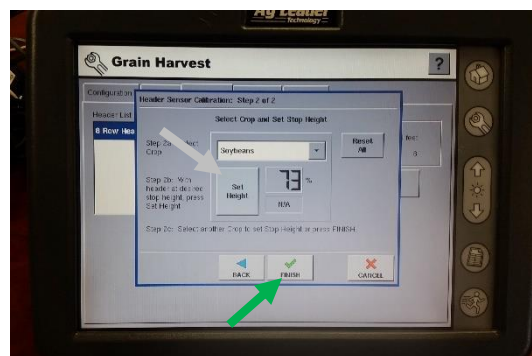
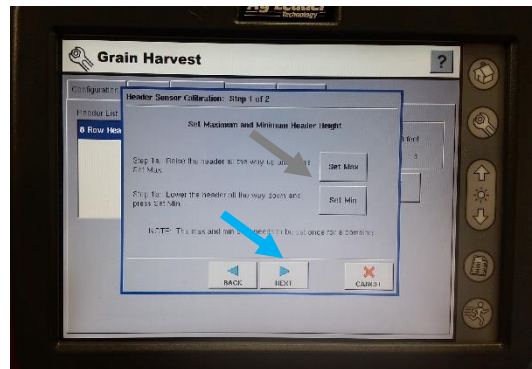
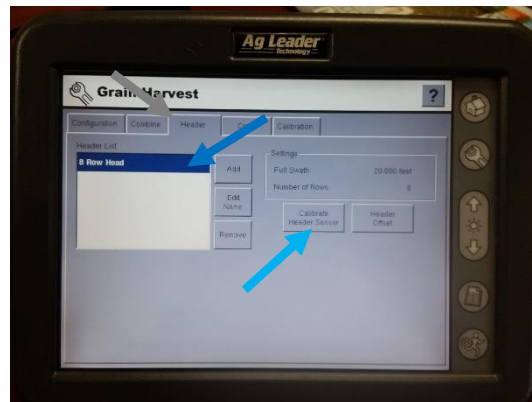
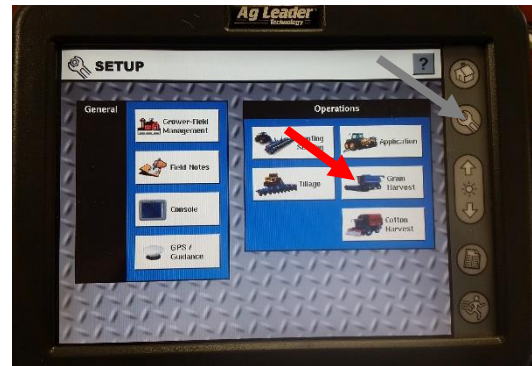

Initial Harvest Calibrations

Ground Speed

1. Press the **Wrench** button to access the setup page. Press on the **Grain Harvest** button.
2. Press the **Combine Tab**. **Highlight** the combine.
3. Press the **Calibrate Distance Button**. Select **Distance**. Read the onscreen message and press **Next**.
4. Measure and mark out a distance greater than 100 ft., 300ft recommended. Change "Actual Distance" to match measured distance. Press Continue. Press **START** and begin driving marked distance. At the end of the track, press **STOP**. Press the **Next** then the **Green Checkmark** to complete calibration.

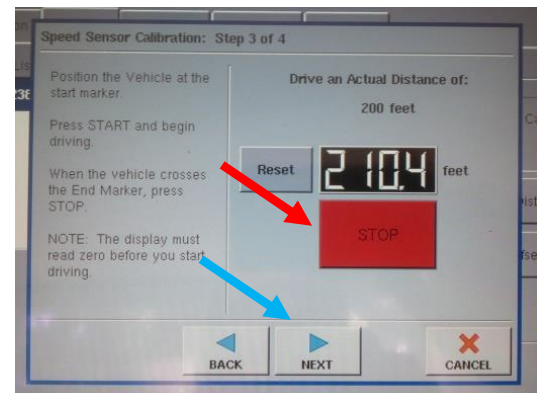
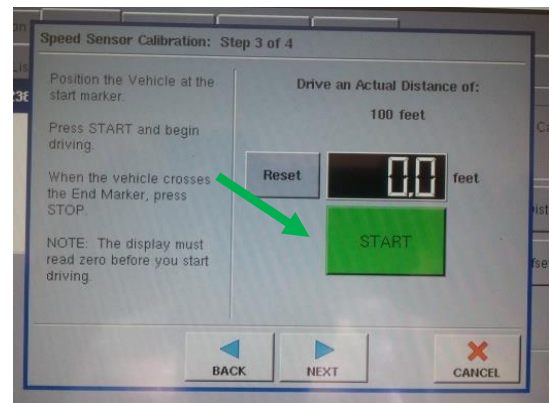
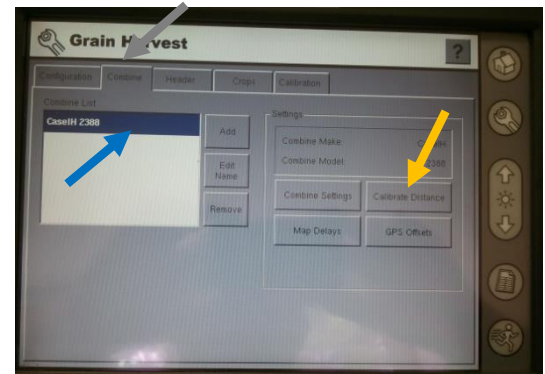
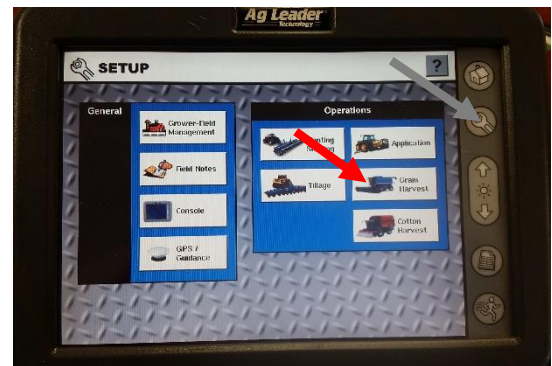

Initial Harvest Calibrations

Vibration

1. With a Field Operation Started, press the **Wrench**. Press the **Grain Harvest Button**.

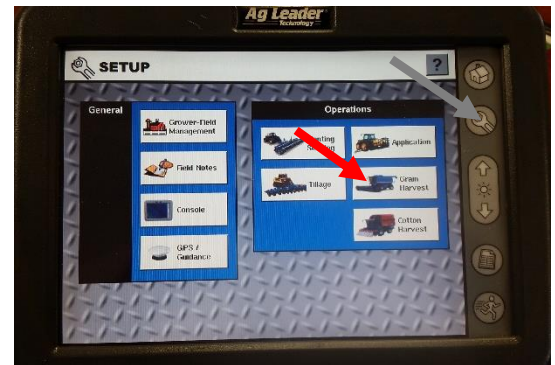

2. Press the **Calibration Tab**. Then press the **Vibration** button.

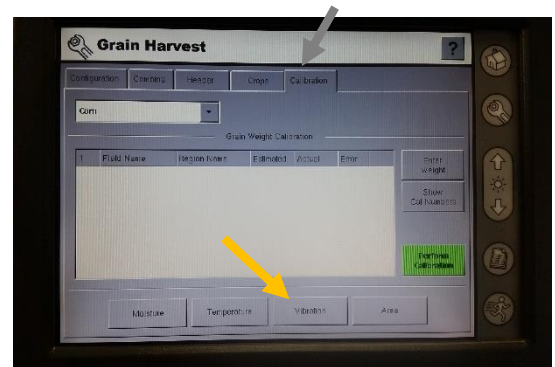

3. To begin calibration, start the separator and engage the header, increase engine speed to full throttle and press **START**.
4. After timer expires, the system will make calculations and will inform you when calibration is completed. Throttle down and disengage. Press the Exit to complete calibration.

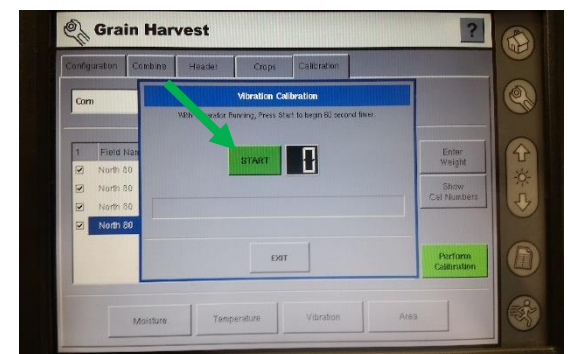

NOTE: Calibration needs to be completed for each head only once. Recalibrate if heads or combine are traded.

Initial Harvest Calibrations

Temperature

1. With a Field Operation Started, press the **Wrench**. Press the **Grain Harvest Button**.
2. Press the **Calibration Tab**. Then press the **Temperature** button.
3. Adjust the temperature using **Up and Down Arrows** to match ambient outdoor temperature. Press **Exit** to finish.

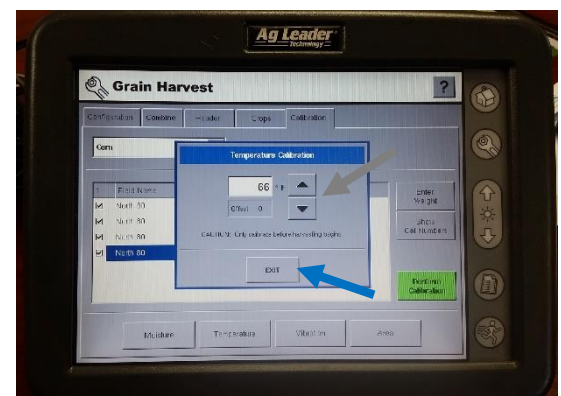
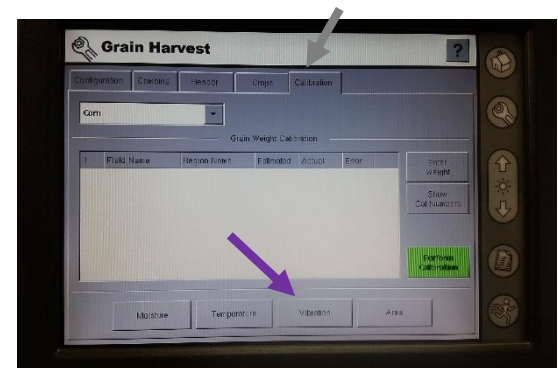
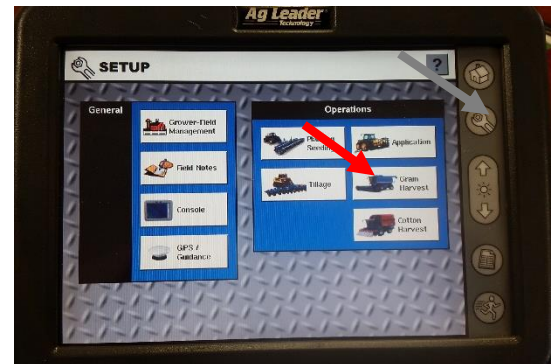

NOTE: The temperature calibration should be performed in the early morning (or in the shade) before the combine has been running, to avoid heat from the machine affecting the reading. This calibration only needs to be completed once per season.